



**PRODUCTS INC.**

www.afwood.com / P: 800 367 3293 / F: 517 545 5633

## Architectural, Commercial, & Industrial Grade Doors, Frames, & Hardware



Wood Doors



**MESKER**

Hollow Metal Doors & Frames



Design Hardware

Contract Hardware



# OPENING GUIDE - Door Details

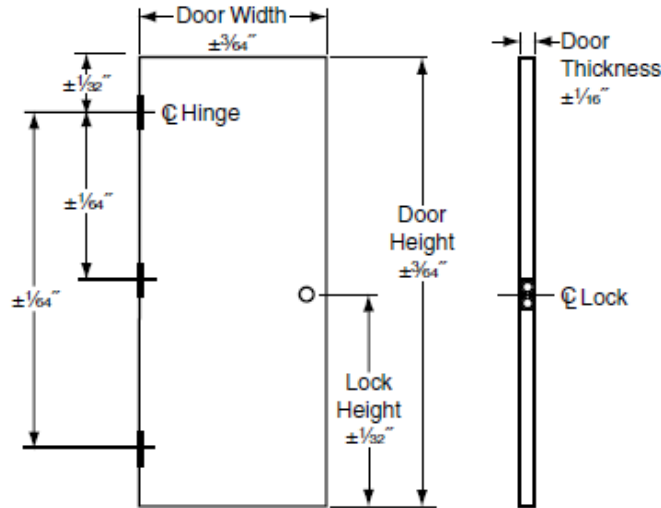

## ● Door Sizes

### Widths: Single Doors

- 20 (2'00")
- 24 (2'04")
- 26 (2'06")
- 28 (2'08")
- 210 (2'10")
- 30 (3'00")
- 34 (3'04")
- 36 (3'06")
- 38 (3'08")
- 310 (3'10")
- 40 (4'00")

### Widths: Double Doors

- 40 2 (2'00")
- 48 2 (2'04")
- 50 2 (2'06")
- 54 2 (2'08")
- 58 2 (2'10")
- 60 2 (3'00")
- 68 2 (3'04")
- 70 2 (3'06")
- 74 2 (3'08")
- 78 2 (3'10")
- 80 2 (4'00")



### Heights:

- 68 (06'08")
- 70 (07'00")
- 72 (07'02")
- 710 (07'10")
- 80 (08'00")

## ● Door Materials

### Hollow Metal: Insulated

- 18 Ga. (Standard)
- 18 Ga. Galv.
- 16 Ga.
- 16 Ga. Galv.
- 14 Ga.
- 14 Ga. Galv.

### 9 Ply Wood: (SC)

- Plain Sliced Red Oak
- Rotary Natural Birch
- Legacys
- Primed Hardboard
- Panel Colonists
- More available...

### 7 Ply Wood: (SC)

- Plain Sliced Red Oak
- Rotary Natural Birch
- Rotary White Birch
- More available...

### 5 Ply Wood: (SC)

- Plain Sliced Red Oak
- Rotary Natural Birch
- White Maple
- Rift Red Oak
- Rift White Oak
- Sliced White oak
- Sliced Cherry
- Honduras Mahogany
- More available...

## ● Door Elevations

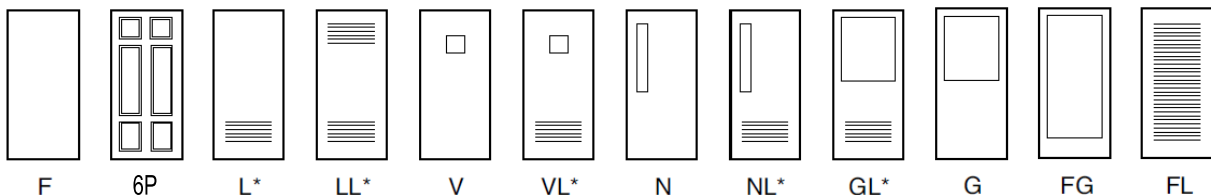

## ● Fire Ratings

Non Rated / 20 Min / 45 Min / 60 Min / 90 Min / 3 Hr

## ● Finish

Unfinished Wood or Primed Steel / Wood Clear Coat / Wood Stain (call for details)

# OPENING GUIDE - Frame Details

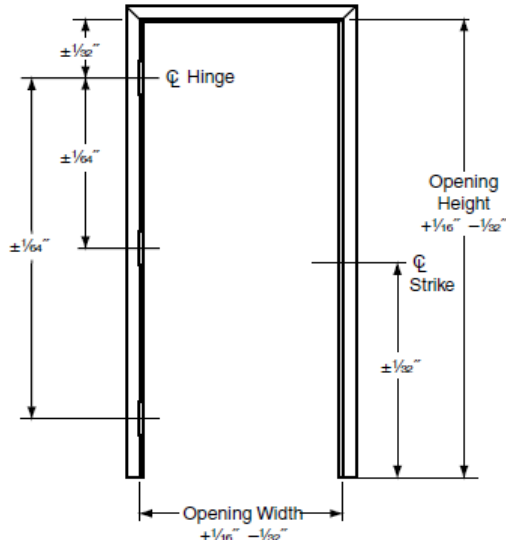

## ● Wall & Anchor Type (HOLLOW METAL)

### Masonry: New

Frame hung during construction

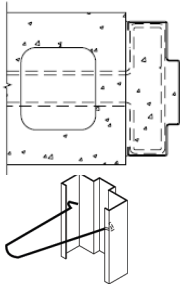

### Masonry: Existing

Remodeling / existing wall

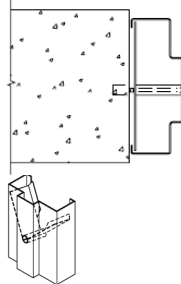

### Stud / Drywall: Welded

Drywall hung after frame

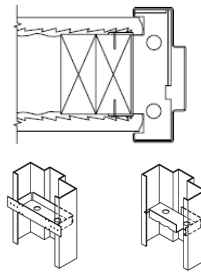

### Stud / Drywall: K. D.

Drywall hung before frame

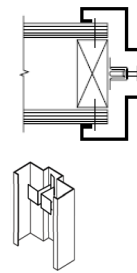

## ● Frame Profile (HOLLOW METAL)

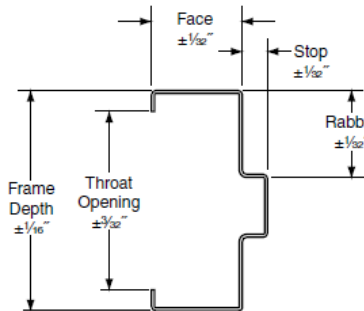

Frame Depth	Throat	Note
4 3/4"	3 3/4"	
5 5/8"	4 5/8"	Stock drywall
5 3/4"	4 7/8"	Stock masonry
5 7/8"	4 7/8"	Stock drywall
6 1/4"	5 1/4"	
6 3/4"	5 3/4"	
7 1/8"	6 1/8"	
7 3/4"	6 3/4"	
8 1/4"	7 1/4"	
8 3/4"	7 3/4"	

\*Custom / other profiles are available upon request

## ● Frame Profile (WOOD)

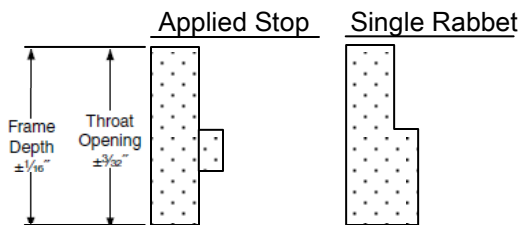

Frame Depth	Throat	Note
4 5/8"	4 5/8"	Stock
4 7/8"	4 7/8"	Stock
5 1/4"	5 1/4"	Stock

\*Custom / other profiles are available upon request

## ● Corners

Face Welded (steel) assembled (wood) / Knock Down hollow metal frames hung after drywall must be KD

# OPENING GUIDE - Hardware Details

## ● Hang Your Door

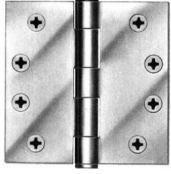

*BB5 NRP* - Grade 1, 4.5" x 4.5", Square, Ball Bearing, Std Weight Hinges, UL Listed, Heavy Weight Available

### Finish Options:

- USP Primed     US26D Dull Chrome     US3 Bright Brass  
 US4 Satin Brass     US26 Chrome     US10B Antique Bronze  
 US15 S. Nickel     US32D Stainless Steel

### Spring Hinges:

- Yes     Not Needed

## ● Latch Your Door

### *Hardware Option 1 - Lock w/ optional deadbolt*



*X Series* - Grade 2, Heavy Duty w/ Thru Bolts, UL Listed, Standard w/ ADA Lever

### Finish Options:

- US26D     US3     US4     US26  
 US10B     US10     US15

### Functions:

- Passage F61     Classroom F84     Entry / Office F82  
 Privacy F76     Storeroom F86     Connecting Room / Exit Latch



*D2 Series* - Grade 2, UL Listed

### Functions:

- No deadbolt     Thumb turn     Double cylinder / Key both sides

### *If double door:*

- No astragal     Astragal

### *Hardware Option 2 - Exit Device*



*1000 & 2000 Series* - Grade 1 Panic, Fire Rated Available, Vertical Rod Available

### Model:

- 2000 Series - Standard Duty     1000 Series - Heavy Duty

### Finish:

- Standard: 1000 Series = US32D / 2000 Series = Powder Coated AL  
 US10B or Dark Bronze     US4 or Gold

### Exterior Trim:

- Keyed Lever     Pull Plate     Heavy Duty Keyed Lever w/ Escutcheon Trim

### *Hardware Option 3 - Push / Pulls*



*Push Plate + Pull Plate*

### Functions:

- US32D

\* Push / Pulls require a door closer or spring hinges

# OPENING GUIDE - Hardware Details

## ● Control Your Door



*116 & 316 Series* - Grade 1, UL Listed, ADA, Spring Power 1-6, Backcheck, Tri  
Packed for Parallel Arm Mount + Wood & Metal Screws

Model:

- 116 Standard Duty - No Cover       316 Medium to Heavy Duty - Cover Included

Finish Options:

- Aluminum       Dark Bronze

## ● Protect Your Door



Kick Plate:

- Yes       Not Needed

Door Stop:

- Yes       Not Needed

- Wall (Convex)
- Wall (Concave)
- Kick Down
- Dome Floor
- Floor



Door Viewer: 200 Degree

- Yes       Not Needed

## ● Seal Your Door

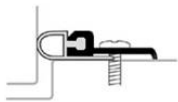

Weatherstrip:

- Yes       Not Needed



ADA Threshold:

- Yes       Not Needed



Door Sweep:

- Yes       Not Needed

# OPENING GUIDE - Handing

## ● Handing

